



POLYDECK®

PROTEX® PSL



Polyurethane (POLY) Side Wear Plates (SWPs) are molded in (2) Sizes: 0.75" x 5.19" and 1.25" x 8.00". Although 48" is the most common length, 60" length is also available. POLY SWPs are molded with a 30° beveled top, which is suitable for wedge and clip installation. These may also be molded with mounting holes/slots.

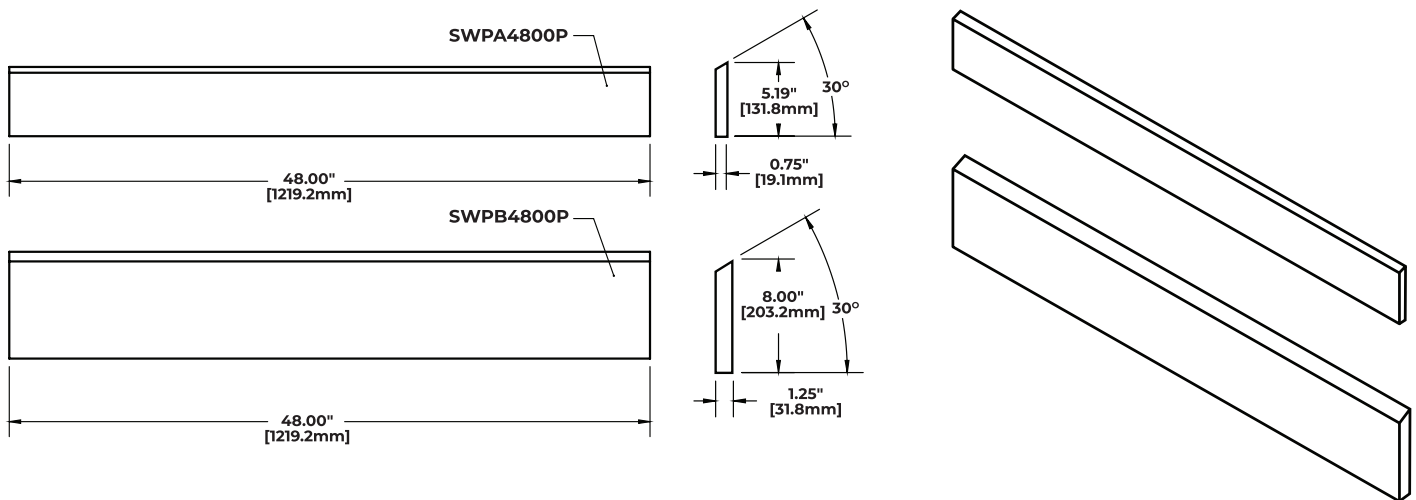

Technical Specifications

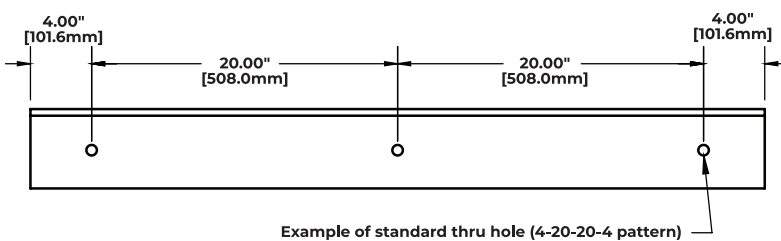

Example of standard thru hole (4-20-20-4 pattern)

Polydeck molds POLY SWPs with a variety of mounting hole options:

Thru-holes, slotted thru-holes, and counter bored versions of each. As these SWPs have a 30° beveled top, the feed material will roll off the beveled tops rather than accumulate on them. The most common hole patterns are 4"-20"-20"-4" (shown above) and 6"-12"-12"-12"-6" (shown to the right.)

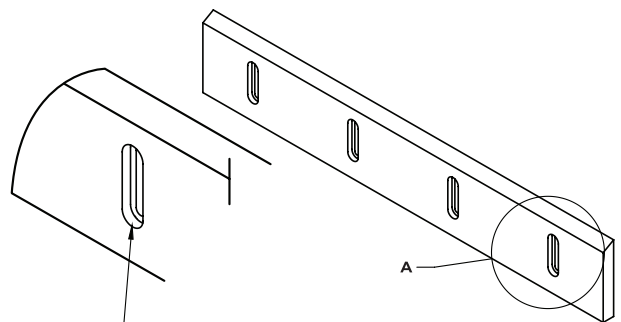

This is an example of a slotted and counter bored POLY SWP with a 6"-12"-12"-12"-6" hole pattern. The counter-bore permits hardware to sit recessed, which prevents excessive wear of the bolt heads.

Applications

POLY SWPs are best suited for moderate to heavy applications, wet applications (wash/rinse screens), and are long lasting/high wear life options.

Corporate Headquarters

1790 Dewberry Road
Spartanburg, SC 29307
Call: +1 864 579 4594

Polydeck Chile, Ltda.

Camino La Vara 03400
San Bernardo, Santiago, Chile 8060123
Sales: +56 2 23801319

Polydeck Peru S.R.L.

Calle Jacinto Ibanez Nro. 315
Urb. Parque Industrial Arequipa -
Megacentro Almacen D-112a, D112b
Sales: +519 4596 6996

polydeck.com